

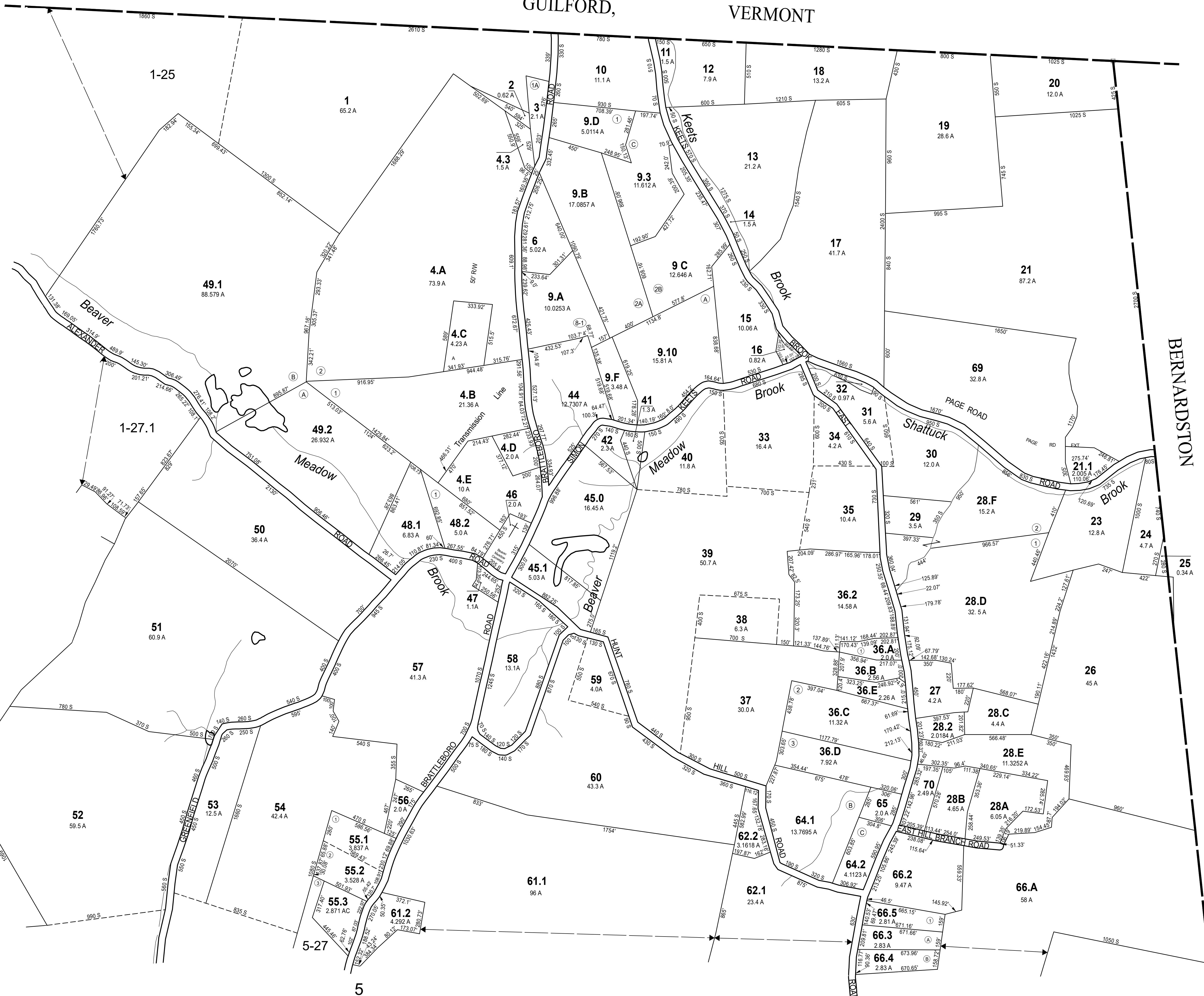

GUILFORD, VERMONT



NO PARCEL: 5.7, 8, 28.1, 43

NOTE
This Map is Not Intended
For Use In Conveyancing
Revised To: January 1, 2022

TOWN OF LEYDEN	
SCALE	SHEET NO.
1" = 400'	2

REVISIONS & REPRINTED BY
CAI Technologies
11 Pleasant Street, Littleton, NH 03561
800.322.4540 - www.cai-tech.com